

Step5/7-Programming system PG-2000

Installation note:

Load your license file using the link given in your personal license email.
The password for extraction can also be found in this email. Then copy this file into the folder of the installed PG-2000 software (demo version).
After restarting the software, your license is active.

<https://www.tpa-partner.de>

Menutree Website:

- + Products / docu / downloads
- + PG-2000 S5-CSF/S7-FBD extension

QR-Code Website:

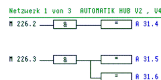

Please make sure to update your drivers before using our products.

Wireless around the Moeller-PLC



Move wirelessly around the Moeller-PLC and communicate for example ONLINE in the status

Data backup S7-PLC over MPI/Profibus on USB-stick

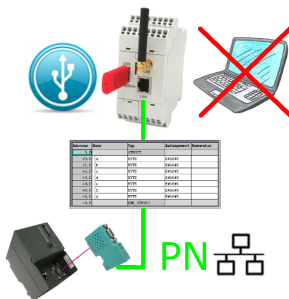

S7-PLC triggered DB-backup/-restore without additional PC via MPI/Profibus on USB-stick

Process energy-data with LOGO!

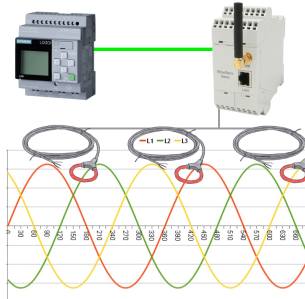

Process of all kinds of the recorded energy-values with the LOGO!-Control

Wireless around the S7-PLC

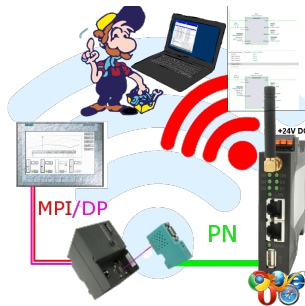

Move wirelessly around the S7-PLC and communicate for example ONLINE in the status

Detect and alarm Profinet burglary



Detection and logging of unauthorized access in the defined Profinet

Attempted break-ins and access to the network are recognized immediately and e.g. reported by email

Logging of all accesses in the network for historical processing

Possible data-storage USB-stick or FTP-server via USB-network-stick.

Remote Maintenance via keyboard and voice

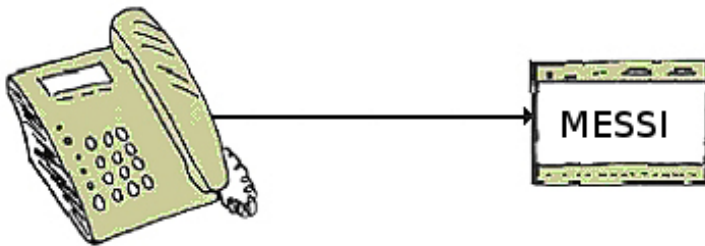

The MESSI remote-station will be called directly by integrated mobile-phone. If a connection comes off, digital In- and Outputs for teleswitching will be transmitted. Each device can both transmit state of things and accordingly receive switch signals.