

### Menutree Website:

- + Products / docu / downloads
- + Hardware
  - + PD-interface-multiplexer
  - + MINI-MUX

### QR-Code Website:



Please make sure to update your drivers before using our products.

## Management of the data-areas

**Datenbereich-Zugriffsschutz**

Schutzmodus: Angegebene Datenbereiche erlauben Hilfe anzeigen

CPU 2	#Bus-Teilnehmer 2
r:md4	#Lesen MB4
r:mb5	#Lesen MB5
w:mb8	#Schreiben MB8
CPU 6	#Bus-Teilnehmer 6
r:mu0,40	#Lesen 40 Markervorte ab M40
w:mu80-90	#Schreiben M40 - M90
CPU 10	#Bus-Teilnehmer 10
r:ew0,10	Lesen 10 Eingangsworte ab EW0

With the management of the data-areas it is determined whether the entered data-areas can be read/written via the module with the connected controllers. A central button for the function determines whether the specified inputs are "allowed" or "not allowed" are.

The input itself is kept very simple: "r" for reading and "w" for writing, a ":" as a separator and then the data-area in S7-format. If there is only one CPU on the bus, the CPU-address does not even have to be specified, the participant on which the module is plugged in is used.

## Process energy-data with LOGO!

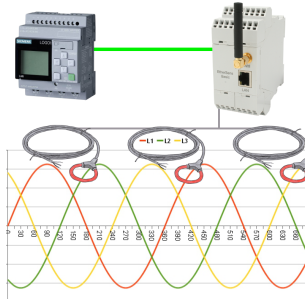

Process of all kinds of the recorded energy-values with the LOGO!-Control

## Bus-connector with diagnostic function

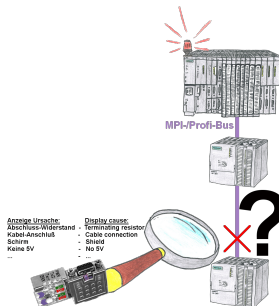

Bus problems and no reason apparent?

Connect the diagnostic-bus-connector to the "suspicious" PLC and read the possible cause of the fault using the blink-code:

- 5V voltage missing/out of specification
- possible short-circuit in the bus
- No bus-activity on the PLC
- Wrong termination
- Bus is open

...

The bus-connectors of the "DiagConn"-series indicate all of these possible causes of the malfunction. The bus-connector is available in 90°, 45° and 0°-versions. The connectors can be attached instead of the "normal" bus-connectors. There does not have to be a fault, the plugs can generally also be used in the bus and you can later find the cause of any

## Data backup S7-PLC over MPI/Profibus on USB-stick via dig. IO

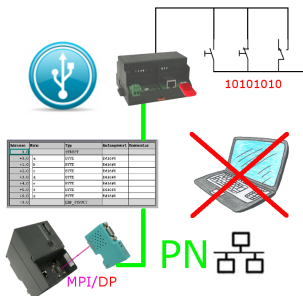

Via digital input triggered DB-backup/-restore without additional PC via MPI/Profibus to USB-stick

## Data backup S7-PLC PN-port on FTP-server via dig. IO

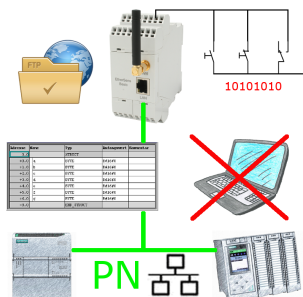

Via digital input triggered DB-backup/-restore without additional PC via PN-port to FTP-server

Malfunctions on the Bus although everything is (apparently) connected properly?

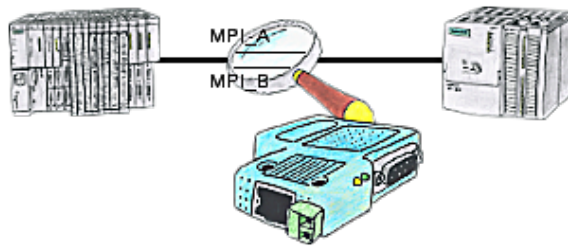

The S7-LAN can also be used for controlling/checking the MPI/Profibus. It will be plugged on the Bus so that you can take a look at the status of the busses via software on PC, for example the numbers of parity errors.

Use on-site without PC-adapter?



With the MPI/PPI/Profibus-modem you can connect serial to your PC/laptop and then communicate directly with the PLC without a PC-adapter or other S7-programming cables.