

Menutree Website:

- + Products / docu / downloads
- + Hardware
 - + Programming devices
 - + Other interface cables

QR-Code Website:



Please make sure to update your drivers before using our products.

Detect and alarm Profinet burglary



Detection and logging of unauthorized access in the defined Profinet

Attempted break-ins and access to the network are recognized immediately and e.g. reported by email

Logging of all accesses in the network for historical processing

Possible data-storage USB-stick or FTP-server via USB-network-stick.

Data backup S5-PLC on USB-stick

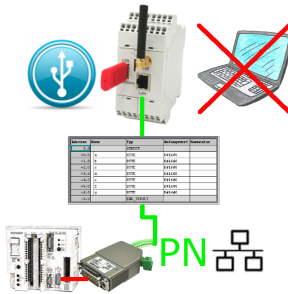

S5-PLC triggered DB-backup/-restore without additional PC via PG-socket and Ethernet on USB-stick

Failure report transmission without any change in the PLC program

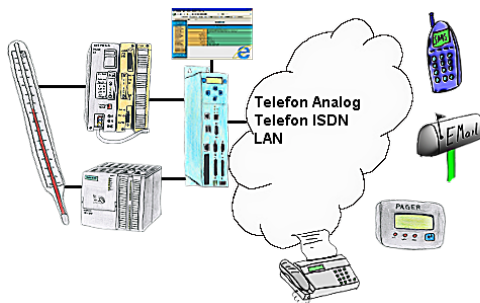

Your outstation reports the current value cyclically, or in case of malfunction the status via FAX, as SMS to your mobile phone, to your pager or also via e-mail. And this without an intervention of the PLC-program. Here the variables and actions are stored and processed in the TP-II.

Remote-maintenance Beckhoff-PLC with firewall



Remote-maintenance of a Beckhoff-controller with network-connection via secure VPN-tunnel and scalable firewall

Complete supply from the PC

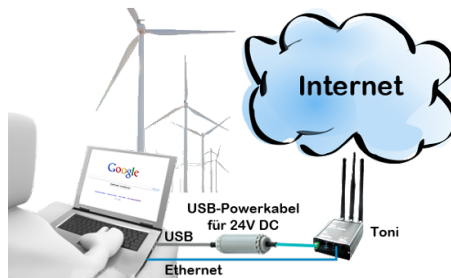

Data backup S5-PLC on SD-card

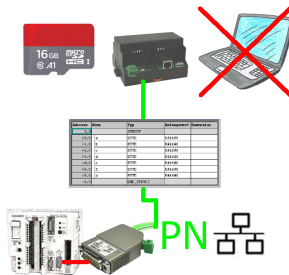

S5-PLC triggered DB-backup/-restore without additional PC via PG-socket and Ethernet on SD-card

Extend MPI/DP-bus over network or convert to network

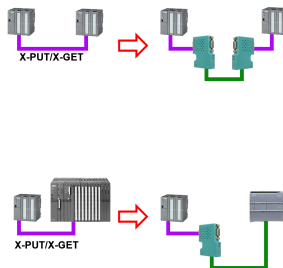

MPI/DP communication between two S7-300/400 controllers on the same bus

- a control is relocated spatially:

2x S7-LAN with activated X_PUT/X_GET module, the data is transported between the modules via the network.

- a control is replaced by a PN control:

1x S7-LAN with activated X_PUT/X_GET module and the received-data are transferred automatically to the configured PN-PLC via PUT/GET.