

Menutree Website:

- + Products / docu / downloads
- + Hardware
 - + Programming devices
 - + S5
 - + S5 over RS232
 - + S5toMPI

QR-Code Website:



Please make sure to update your drivers before using our products.

PD-interface of the S5-PLC already occupied (service device)

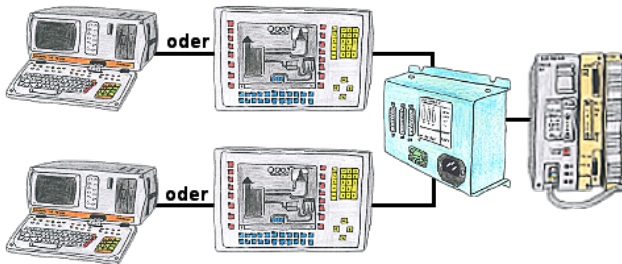

Your PD-interface of the S5-PLC is already occupied with a panel and you should accomplish program modifications without removing the panel? No problem, connect the Multiplexer one-time to the PLC and then connect the panel and also your PC to the Multiplexer. Now you can work parallel with the PLC without the need of affecting the operation of the panel. You can even work with 2 programming devices simultaneously, 2x open the same block, only changes which are stored at last will be finally stored in the PLC. Also ideal for trainings purposes if PLC's with IO's are scare goods.

PG-MUX-II is the ultimate service-device, regardless of what you plug into the two PG-sockets, both participants communicate parallel with the controller.

PLC-coupling (data exchange between PLC-devices)

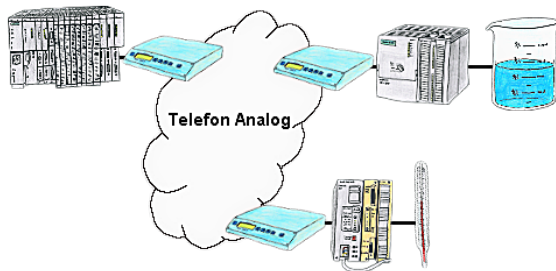

Your pumping stations report the water levels of the central control via telephone network. The central office itself can of course transmit commands/messages to the substations as well. Thereto no dedicated line is required, a "normal" telephone connection is sufficient because the devices hangs up the line after occurred message.

BOSCH-CL <=> S7-TCPIP

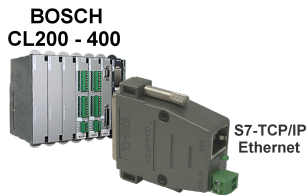

Bring your BOSCH-CL control CL200 - CL400 into the network

Link the PLC with your production-data-acquisition or other Industry 4.0-applications

Communicate with the controller as if you were talking to an S7-PLC, but the data comes from the CL-PLC

Networking CL-controllers without much effort (set the IP-address to match your subnet in the module, nothing more)

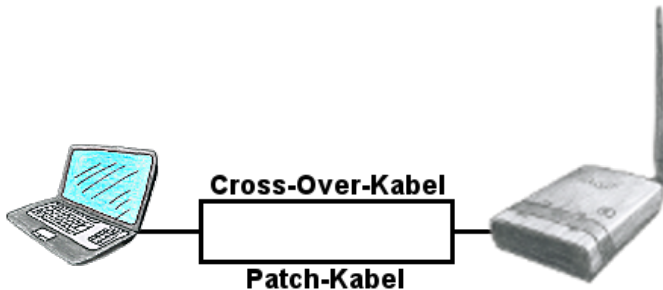

You need ALF to connect to a reachable WLAN, but only have a patch-cable? No problem, ALF provides "autonegotiation" and this means that he recognises a connected cable (patch-cable or cross-over-cable) and surround the pinning according to the cable, so a communication is possible.

Access to MPI/Profibus without power supply

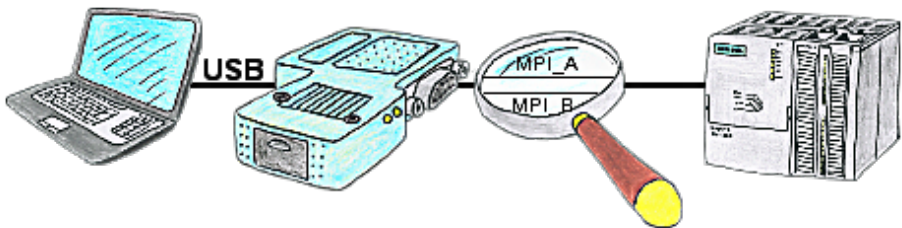

You're right in the middle of your production line and are standing in front of a passive assembly just like a switcher or a ET200, in that case you won't be able to go Online without an external power supply of your programming adapter, unless you're using the S7USB. This module is supplied completely from the USB-interface.

Data backup S5-PLC on SD-card

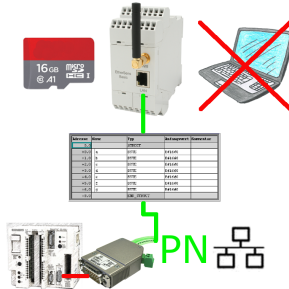

S5-PLC triggered DB-backup/-restore without additional PC via PG-socket and Ethernet on SD-card

LOGO! - not just a small controller

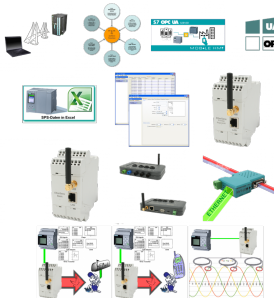

For many PLC programmers and PLC users, the LOGO! a "toy", but that's not the case.

The LOGO! is a small-control that also finds its use. With the tools and hardware devices around the LOGO!-PLC, the user can process information in and from the LOGO! PLC.

Regardless of whether current-/voltage-values are stored in the LOGO! is to be processed, the LOGO! sent E-mail-messages, here the user will find many products related to LOGO!.