

# Handling-Short Instruction for

## MESSI NG 2G / 3G V1.0



The Messi is a fault-messenger which sends its fault-messages via the GSM-network. As a result, it is not affected by german telekom's switch to the digital telephone-network.

### Power Supply MESSI

Connect the following voltage to input terminals 41 and 42:

Terminal 41: +12V DC up to +24V DC

Terminal 42: 0V

Terminal 43: can be used as replacement-supply with accu-pack . Read more in the device-manual.

*Software drivers do not need to be installed.*

### Configuration of MESSI

All data and parameters which are necessary for the operation of MESSI NG are entered via the web-interface. Please use Mozilla Firefox browser to configure the web-server.

Microsoft Internet-Explorer is not suitable for this configuration.

### Preparation

Connect the MESSI NG to your PC or to your existing network with a network-cable. If the control-lamps on the network-socket do not light up, you have to use a crossover-network-cable.

The IP-address of MESSI NG is shown in the display. If necessary, change the IP-settings of your PC so that it is in the same subnet as MESSI NG.

If MESSI NG has the IP address:

192.168.1.200 (factory-settings),

please set up your PC, for example to 192.168.1.3.

You can open the web-interface of MESSI NG with <http://192.168.1.200>. The web-interface transfers only the absolutely needed data, so a smooth processing of programming is possible. After entries on the configuration-pages, please use the save-button to store this settings. Please don't use the back- and forward buttons of the browser.

The browser must allow the processing of javascript.

## Country-specific settings for the cellular network

Due to the technical development of the cellular network, some existing cellular standards will no longer be available.

Unfortunately, the dismantling is carried out according to different guidelines in the individual countries.

The 2G network has not been available in Switzerland since 2020.

The 3G networks in Germany will be switched off in the course of 2021.

Depending on where the MESSI NG 3G is used, this requires differentiated settings.

These are to be set in the “General Settings” (see also chapter “4.3.1 General Settings” in the manual) under “Network Type”.

### For use in Switzerland:

Here the MESSI NG 3G must be set to the 3G network:

**Network Type:      3G**

### For use in Germany:

Here the MESSI NG 3G must be set to the 2G network:

**Network Type:      2G**

<https://www.tpa-partner.de>

(c) copyright 2000-2025 by TPA

### Menutree Website:

- + Products / docu / downloads
- + Hardware
  - + Error messaging
  - + MESSI NG 2G

### QR-Code Website:



Please make sure to update your drivers before using our products.

Integrated dhcp-server

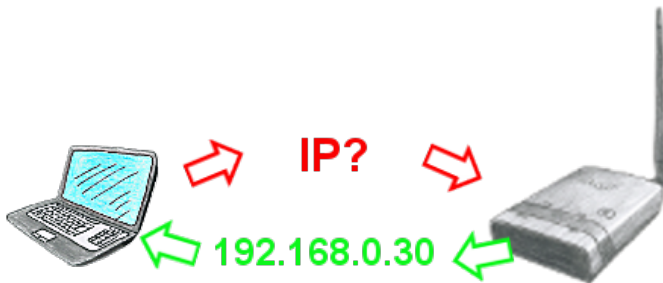

You use your PC in your company network with DHCP, so you don't have to care the everlasting setting of the ip-address. No problem, ALF also can be configured as a DHCP-server and assigns you accessing to the device via LAN or WLAN an ip-address from a predefined address range.

## Detect and alarm Profinet burglary



Detection and logging of unauthorized access in the defined Profinet

Attempted break-ins and access to the network are recognized immediately and e.g. reported by email

Logging of all accesses in the network for historical processing

Possible data-storage USB-stick or FTP-server via USB-network-stick.

## Data backup S5-PLC on USB-stick

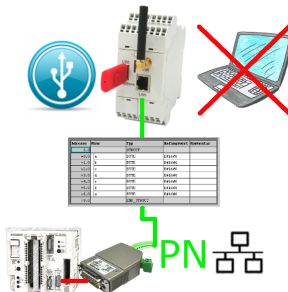

S5-PLC triggered DB-backup/-restore without additional PC via PG-socket and Ethernet on USB-stick