

**Menutree Website:**

- + Products / docu / downloads
- + Accessories
  - + Antennas / Accessories
  - + Magnetic base antenna

**QR-Code Website:**



Please make sure to update your drivers before using our products.

**Profinet WLAN panel connection**



Simply connect your panel to your Profibus via WLAN.

Mobile workplaces are optimally connected.

You will be able to link additional applications such as PDs, visualizations or ERP systems at the same time.

## Serial communication to the S5-PLC

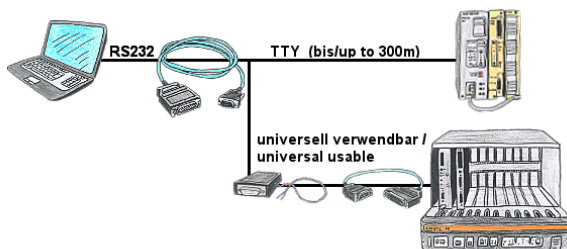

Universally to the S5-PLC, free 9-pin COM-port is sufficient on the PC and free PG-port on the PLC.

No external supply necessary as long as PLC offers current-sources on the PG-interface. Distance to PLC up to a maximum of 300m over 4-wire connection. Each S5-PLC can be connected, also 25-pin AS511 plug-in-card (S5-150U) via net-adapter and AG-150-adapter.

## Extend MPI/DP-bus over network or convert to network

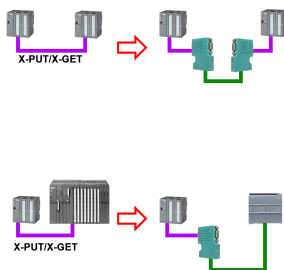

MPI/DP communication between two S7-300/400 controllers on the same bus

- a control is relocated spatially:

2x S7-LAN with activated X\_PUT/X\_GET module, the data is transported between the modules via the network.

- a control is replaced by a PN control:

1x S7-LAN with activated X\_PUT/X\_GET module and the received-data are transferred automatically to the configured PN-PLC via PUT/GET.

## Remote-maintenance Pilz-PLC



Remote-maintenance of a Pilz-controller with network-connection via secure VPN-tunnel of the TeleRouter

## Data backup S7-PLC PN-port on USB-stick

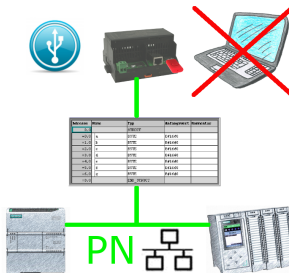

S7-PLC triggered DB-backup/-restore without additional PC via PN-port to USB-stick

## Universal communication at all interfaces

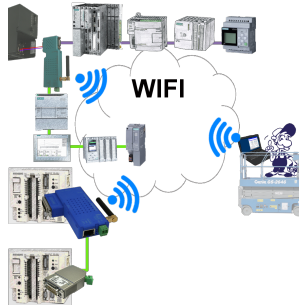

Wired or wireless communication (WIFI) via the same adapter with the respective control Devices from the BRIDGE-family always connect a wired-network with a wireless-network (WIFI) and a specific PLC-interface. This gives you access to the directly connected controller via WIFI (with S7 to the entire bus) as well as to the wired Ethernet. Of course also from wired Ethernet to WIFI and control/bus.

Always connected to each other, all made possible by the devices of the BRIDGE-family.

## S7-CP-alternate (without LAN-CP to the PLC)

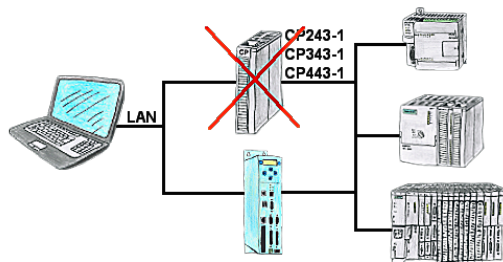

Do you have a PLC without CP343-1 or CP443-1 and a TP-II as remote maintenance device? Then activate the CP-mode of the TP-II and your visualisation goes directly ONLINE via the LAN of the TP-II.