

Menutree Website:

- + Products / docu / downloads
- + Accessories
 - + Connector plug / equipment
 - + Connection cable MPI - X to Cheap

QR-Code Website:



Please make sure to update your drivers before using our products.

Extension of a 3964R-line via LAN

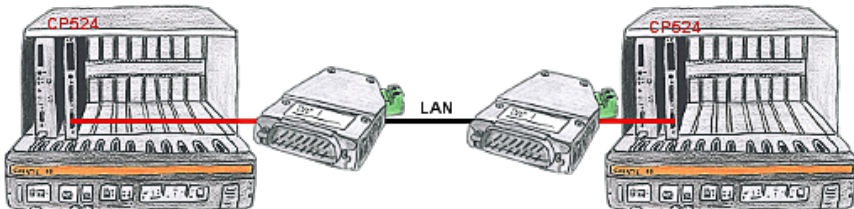

There is a control with CP524 in your outstation and the communication partner of the CP has moved locally. Connecting path is a LAN-network. So each of both participants gets a 3964R-LAN and after input of the partner's IP-address a coupling via LAN will be configured.

Data backup S7-PLC over MPI/Profibus on USB-stick

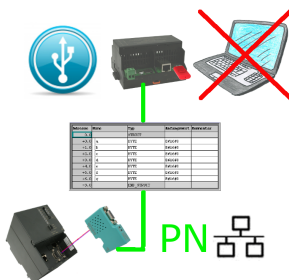

S7-PLC triggered DB-backup/-restore without additional PC via MPI/Profibus on USB-stick

Use in the car with a 12V supply only

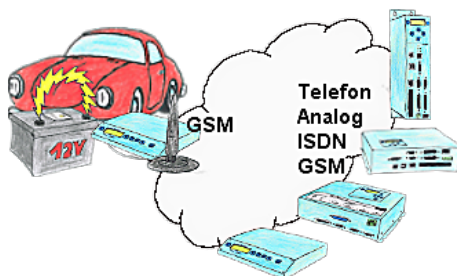

You're on road with your car and your employee reports a failure? What next? Approach the next parking place and try to get a telephone line to solve the problem? Or solve the problem in your head? Hit the next parking place and start your Tele-Book which is plugged on your car's cigarette lighter, and build-up a connection to your installation. With the notebook you will solve the problem within a short time.

Atomic time at the PLC

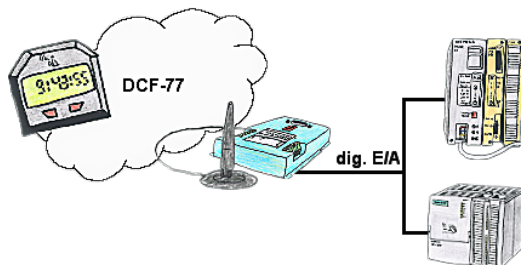

For your production flow you're always in need of an exact time? No problem, connect the SPS-Clock with 4 digital in-/outputs of your PLC, after synchronisation of the SPS-Clock the updating time can be read in a DB of the PLC.

Operation as a WLAN-client

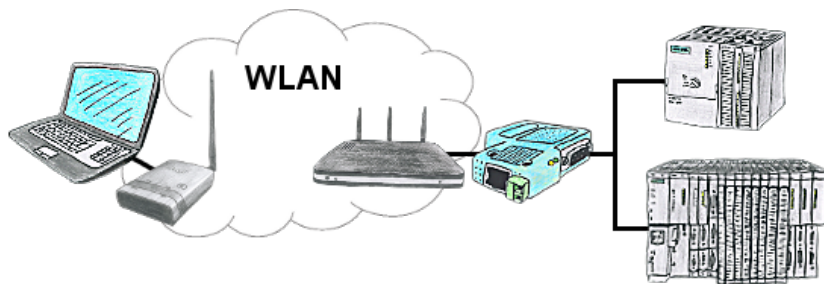

You are on site your plant and should move round the machine and simultaneously control or monitor. WLAN is reachable, but your PC is not able to provide WLAN. No problem, you parametrize ALF as a client and connect him to the PC and join the reachable WLAN and you are online on the PLC.

Data backup S7-PLC over MPI/Profibus on SD-card

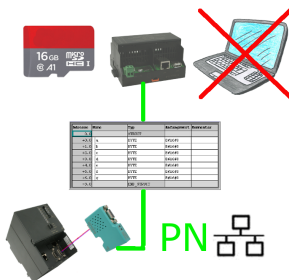

S7-PLC triggered DB-backup/-restore without additional PC via MPI/Profibus on SD-card

To switch a MESSI-output via SMS



SMS-Versenden.
PASS=12345 DO1=1,16

```

PASS=12345 DO1=1,16
| | | | | 15 Sekunden Schaltzeit (0 bedeutet dauernd an)
| | | | | 1 = EIN, 2 = AUS (Bei AUS wird keine Schaltzeit beachtet)
| | | | | DO1 Schlüsselwort für Digitalausgang (DO1 bis DO8 möglich)
| | | | | Passwort aus dem Messpunkt Geräteeingang
| | | | | Schlüsselwort für Passwort
    
```

Switching an output via SMS is an integrated function of the MESSI. Herewith the switching operation will be secure and comprehensible from afar.