

Menutree Website:

- + Products / docu / downloads
- + Hardware
 - + Programming devices
 - + S5
 - + S5 over RS232
 - + S5toMPI

QR-Code Website:



Please make sure to update your drivers before using our products.

Wireless around the machine with LAN-port



Move wirelessly around the machine with LAN-port and communicate for example ONLINE in the status

Connecting S7-PLCs without head-station

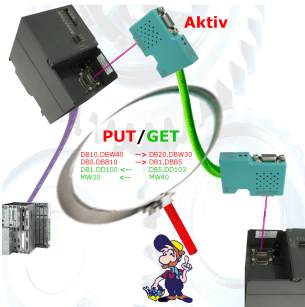

Direct data-exchange between S7-PLCs with S7-LAN.

Thanks to active PUT/GET directly in the module without superordinate head control!

Transfer data directly from one MPI/Profibus-PLC to another.

Bus independent! MPI-bus Profibus / Profibus Profibus / MPI-bus MPI-bus

Data backup S7-PLC over MPI/Profibus on SD-card

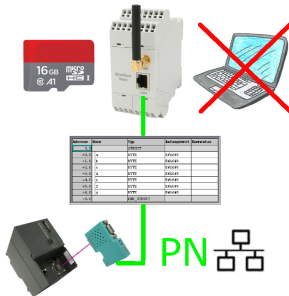

S7-PLC triggered DB-backup/-restore without additional PC via MPI/Profibus on SD-card

Remote maintenance of centralized PLC-devices

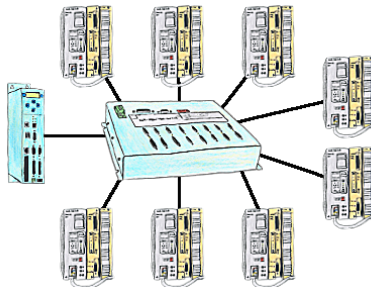

You have many PLC and you want to programm them central on one place? No problem, you have to connect them all to the KOR/MUX-Tele-Switch, connect it with the TP-II and after telephone connect you will be able with the PD-bus-selection of your Step5-software to go ONLINE. Of course the MOR/MUX-Tele-Switch is cascable, so you can connect up to 30 PLCs to the devices.

PLC-data in Excel-readable file



Save your PLC content, production-data in a file on your PC. This file, a CSV- or XML-file (depending on the license), can then be used e.g. further processed with Excel.

A file that includes all configured variables in an infinitely-long list with a suitable time-stamp, either controlled by the PC or via a PLC-trigger (depending on the license). No matter which Siemens-control, as soon as a network-connection is available, nothing stands in the way of recording.

With S7-LAN for PPI, MPI or Profibus or S5-LAN++ for S5-controllers, PLCs without a network-connection can also be addressed and recorded. And depending on the license are several parallel connections possible.

Serial communication with CP and more S5-assemblies

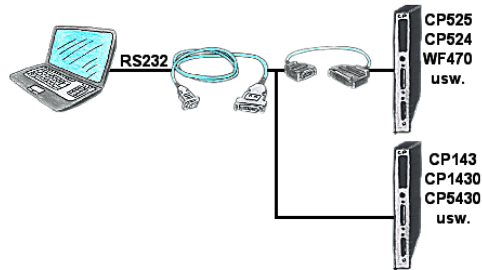

You have a PC with programming software and a 9pin COM-port as interface? No problem, for this purpose the PG-UNI-II-cable is exactly the right product. Connect it to a Siemens assembly such as H1-CP (CP1430), WF470 and PC or CP-525 with the CP525-adapter and PC and you're Online.

Capture data and control independently

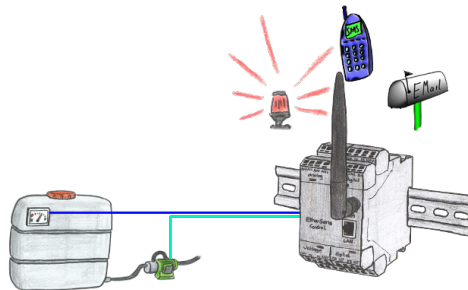

Apply small control tasks of your systems with EtherSens-Control-devices. Determine switching points where the device is running to respond. Depending on the parameterization, an email or SMS notification (depending on the device-configuration) or the device automatically controls via the optional IO-modules (analog / digital / relay).